

Package Outline Drawing

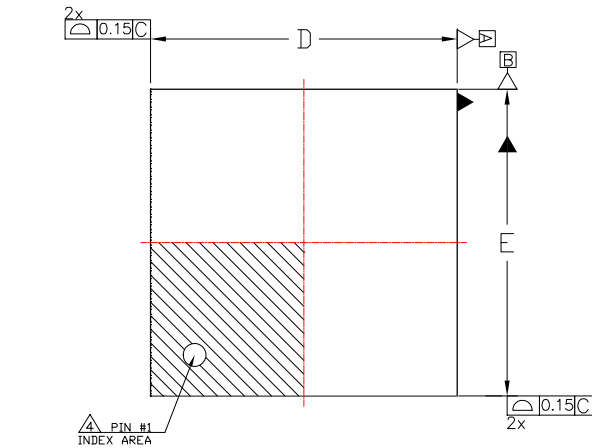

[TOP VIEW]

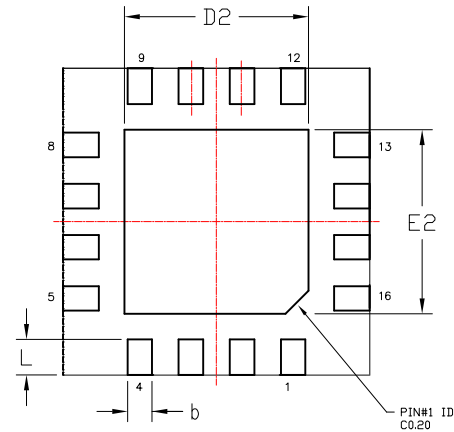

[BOTTOM VIEW]

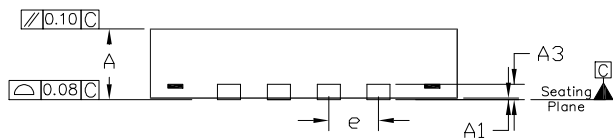

[SIDE VIEW]

NOTES:

1. Dimensioning and tolerancing conform to ASME Y14.5-2009.
2. All dimensions are in millimeters.
3. N is the total number of terminals.
4. The location of the marked terminal #1 identifier is within the hatched area.
5. ND and NE refer to the number of terminals each D and E side respectively.
6. Coplanarity applies to the terminals and all other bottom surface metallization.

SYMBOL	Common					
	DIMENSIONS MILLIMETER			DIMENSIONS INCH		
	MIN.	NOM.	MAX.	MIN.	NOM.	MAX.
A	0.70	0.75	0.80	0.028	0.030	0.031
A1	0.00	0.02	0.05	0.000	0.001	0.002
A3	0.203 Ref.			0.008 Ref.		
b	0.18	0.24	0.30	0.007	0.009	0.012
D	2.90	3.00	3.10	0.114	0.118	0.122
E	2.90	3.00	3.10	0.114	0.118	0.122
D2	1.65	1.70	1.75	0.065	0.067	0.069
E2	1.65	1.70	1.75	0.065	0.067	0.069
e	0.50 BSC			0.020 BSC		
L	0.30	0.35	0.40	0.012	0.014	0.016

Package Size: 3.0x3.0x0.75mm
Exposed Pad Size: 1.70x1.70mm
PIN Pitch: 0.50mm
Number of Pad: 16

Remarks:

Date: 2022/07/18

Title: BSW_4x4_16L_P220718v10

Version: Rev1.0

BeRex Confidential



BEREX

Land Pattern Recommendation

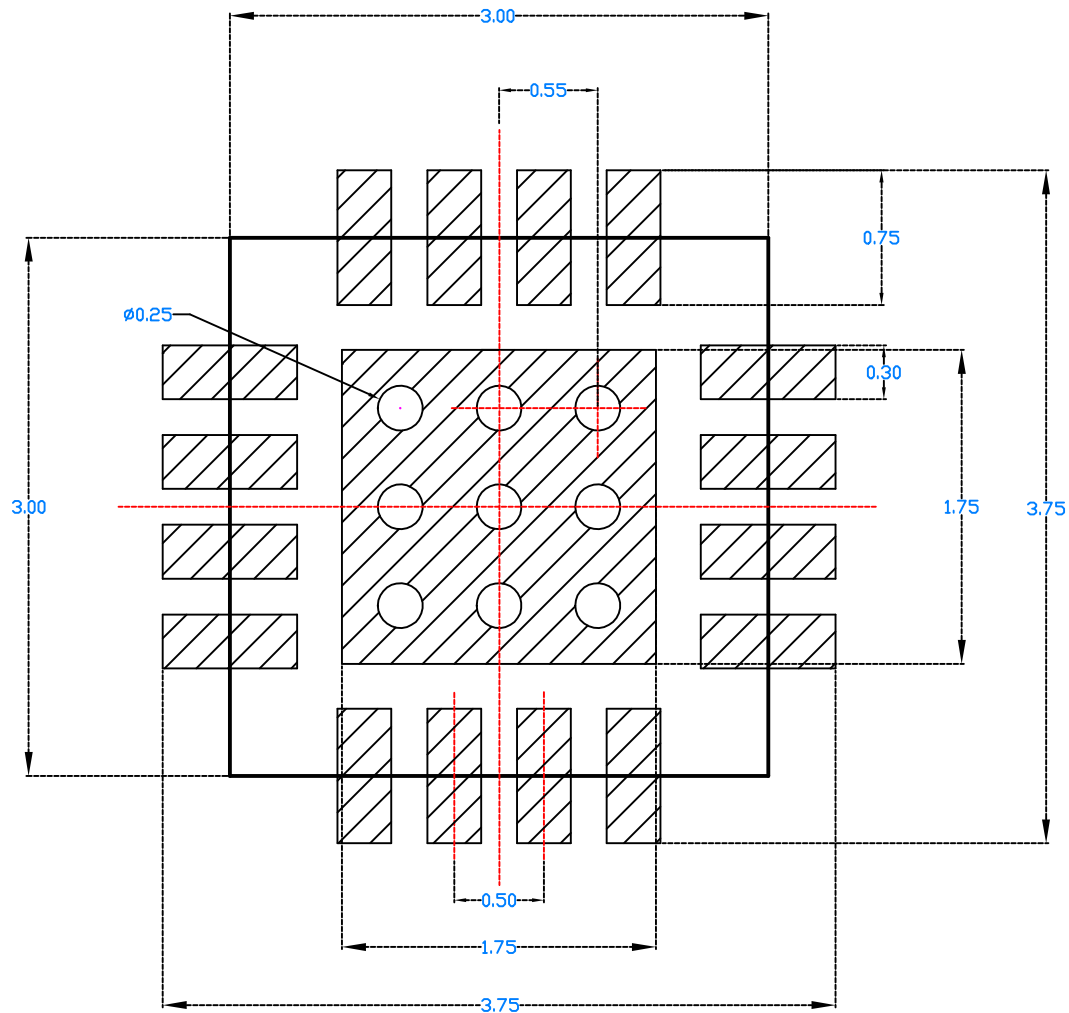

NOTES:

1.All dimensions are in millimeters.

Exposed Pad Size: 1.75x1.75mm
PIN Pitch: 0.5mm
Number of Via: 9
Via diameter: 0.25mm
Exposed Pad via pitch: 0.55mm

BeRex Confidential

Remarks:

Date: 2021/10/18

Title: BSW-3x3-16L-LP211018

Version: Rev1.0



BEREX