

Package Outline Drawing

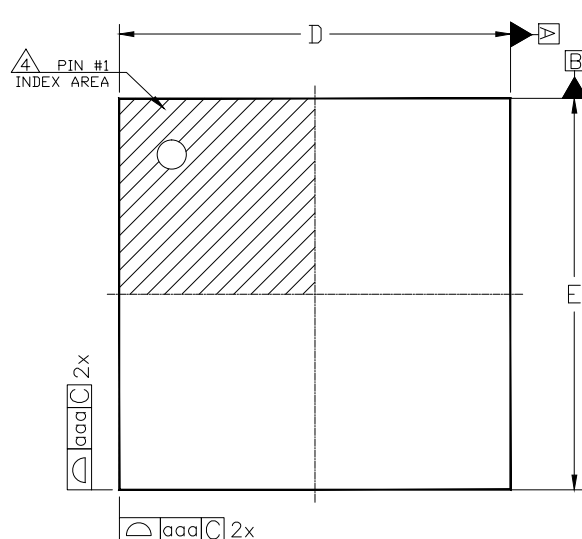

[TOP VIEW]

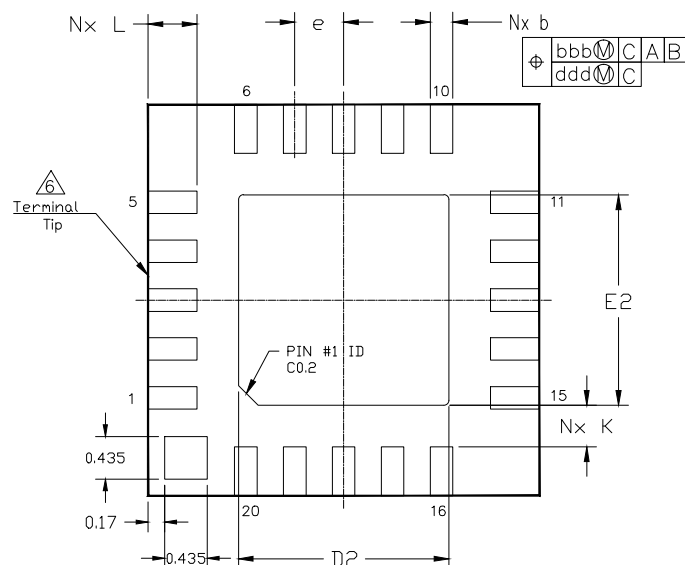

[BOTTOM VIEW]

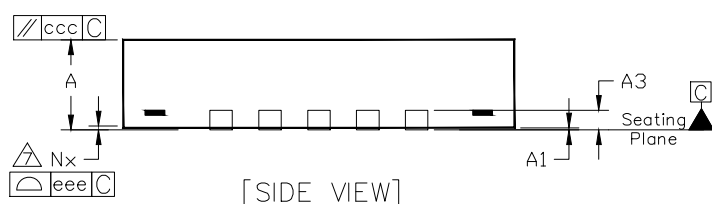

[SIDE VIEW]

NOTES:

1. Dimensioning and tolerancing conform to ASME Y14.5–2009.
2. All dimensions are in millimeters.
3. N is the total number of terminals.
4. The location of the marked terminal #1 identifier is within the hatched area.
5. ND and NE refer to the number of terminals each D and E side respectively.
6. Dimension b applies to the metallized terminal and is measured between 0.15mm and 0.3mm from the terminal tip. If the terminal has a radius on the other end of it, dimension b should not be measured in that radius area.
7. Coplanarity applies to the terminals and all other bottom surface metallization.

Dimension Table (Note 1,2)

Symbol	Thickness	Min	Nominal	Max	Note
A		0.80	0.90	1.00	
A1		0.00	0.02	0.05	
A3		---	0.203 Ref.	---	
b		0.18	0.23	0.28	6
D			4.00 BSC		
E			4.00 BSC		
e			0.50 BSC		
D2		2.10	2.15	2.20	
E2		2.10	2.15	2.20	
K		0.2	---	---	
L		0.45	0.55	0.65	
aaa			0.05		
bbb			0.10		
ccc			0.10		
ddd			0.05		
eee			0.08		
N			20		3
ND			5		5
NE			5		5

Package Size: 4.0x4.0x0.9mm
Exposed Pad Size: 2.15x2.15mm
PIN Pitch: 0.5mm
Number of Pad: 21

Remarks:

Date: 2022/03/07

Title: BVA-4x4-20L-P220307v10

Version: Rev1.0

BeRex Confidential



Land Pattern Recommendation

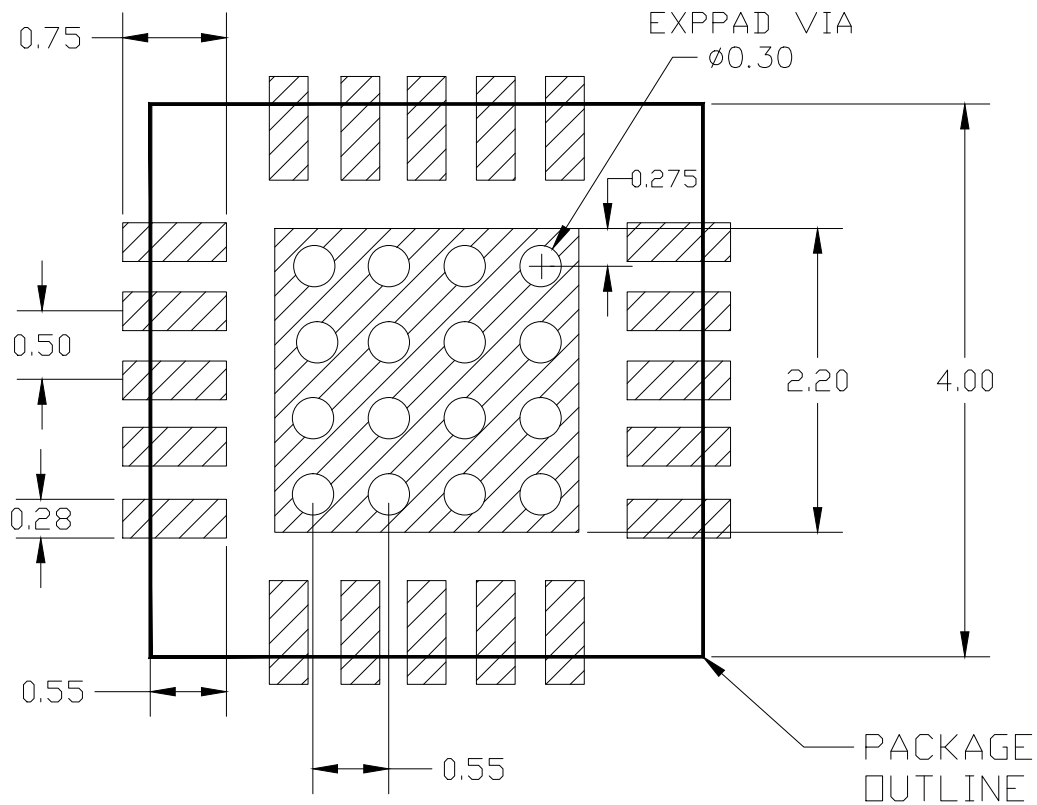

NOTES:

1.All dimensions are in millimeters.

Exposed Pad Size: 2.2x2.2mm
PIN Pitch: 0.5mm
Number of Via: 16
Via diameter: 0.3mm
Exposed Pad via pitch: 0.55mm

BeRex Confidential

Remarks:

Date: 2021/10/20

Title: BDA-4x4-20L-LP211020

Version: Rev1.0



BEREX