

Package Outline Drawing

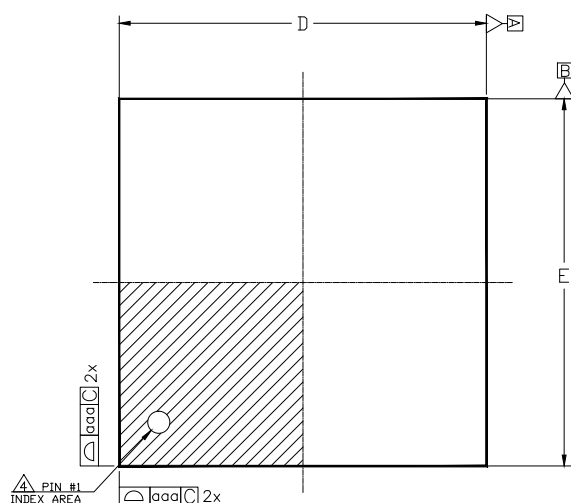

[TOP VIEW]

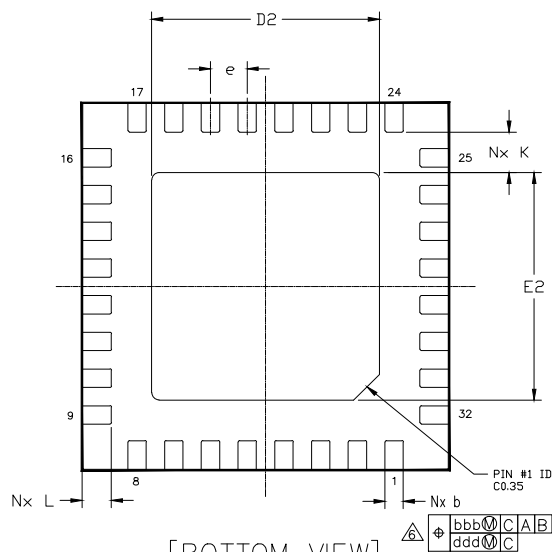

[BOTTOM VIEW]

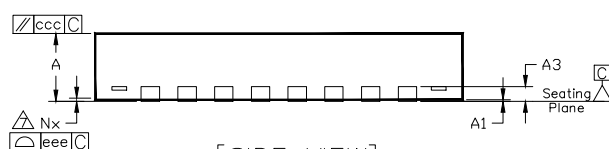

[SIDE VIEW]

NOTES:

1. Dimensioning and tolerancing conform to ASME Y14.5–2009.
2. All dimensions are in millimeters.
3. N is the total number of terminals.
4. The location of the marked terminal #1 identifier is within the hatched area.
5. ND and NE refer to the number of terminals each D and E side respectively.
6. Dimension b applies to the metallized terminal and is measured between 0.15mm and 0.3mm from the terminal tip. If the terminal has a radius on the other end of it, dimension b should not be measured in that radius area.
7. Coplanarity applies to the terminals and all other bottom surface metallization.

Dimension Table (Notes 1,2)

Symbol	Thickness	Min	Nominal	Max	Note
A		0.80	0.90	1.00	
A1		0.00	0.02	0.05	
A3		---	0.20 Ref.	---	
b		0.15	0.25	0.30	6
D		5.00 BSC			
E		5.00 BSC			
e		0.50 BSC			
D2		3.05	3.10	3.15	
E2		3.05	3.10	3.15	
K		0.2	---	---	
L		0.30	0.40	0.50	
aaa		0.05			
bbb		0.10			
ccc		0.10			
ddd		0.05			
eee		0.08			
N		32			3
ND		8			5
NE		8			5

Package Size: 5.0x5.0x0.9mm
Exposed Pad Size: 3.10x3.10mm
PIN Pitch: 0.5mm
Number of Pad: 33

Remarks:

Date: 2022/02/22

Title: BVA-5x5-32L-P220306v10

Version: Rev1.0

BeRex Confidential



BEREX

Land Pattern Recommendation

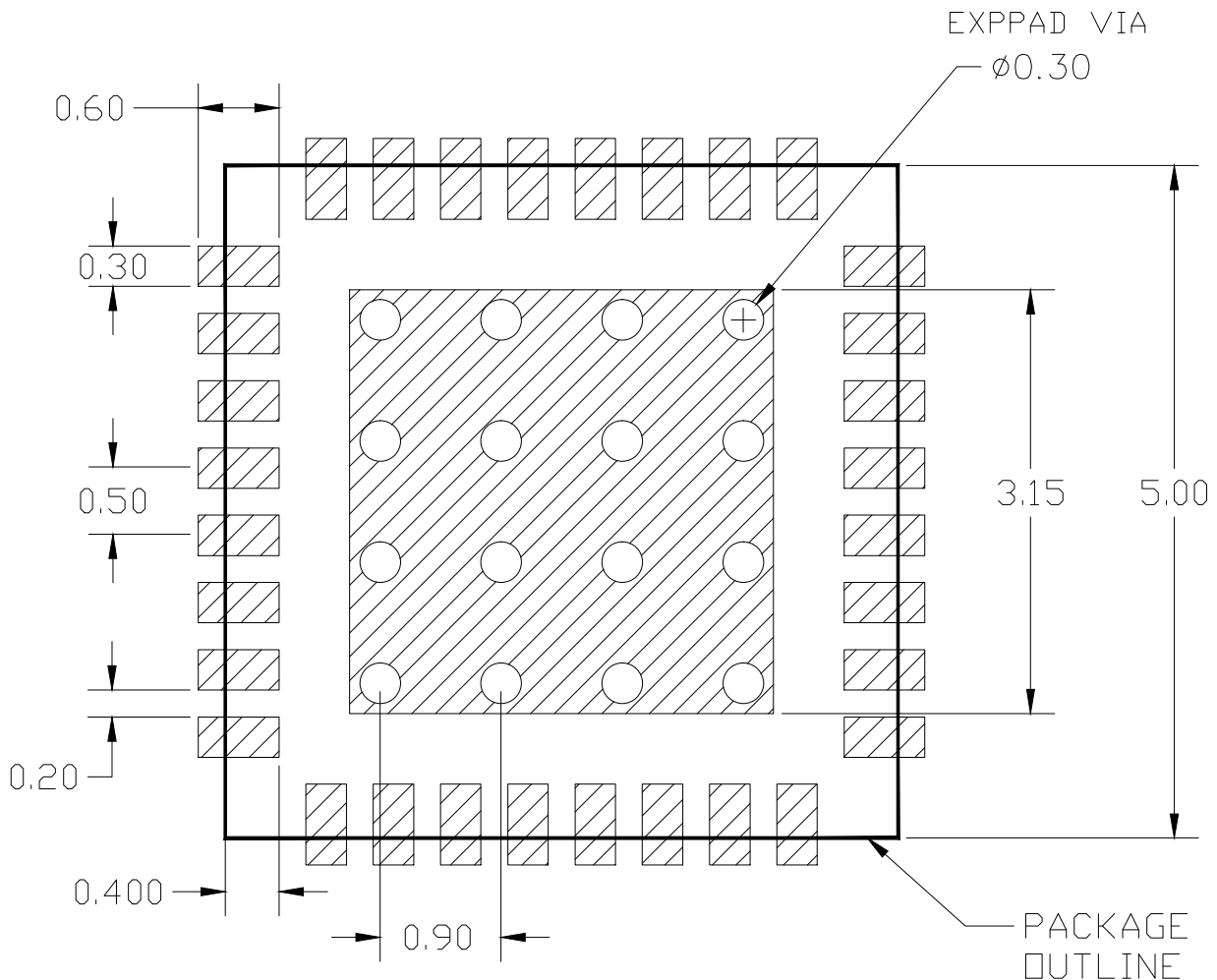

NOTES:

1.All dimensions are in millimeters.

Exposed Pad Size: 3.15x3.15mm
PIN Pitch: 0.5mm
Number of Via: 16
Via diameter: 0.3mm
Exposed Pad via pitch: 0.7mm

BeRex Confidential

Remarks:

Date: 2021/10/22

Title: BDA-5x5-32L-LP211022

Version: Rev1.0

