

Package Outline Drawing

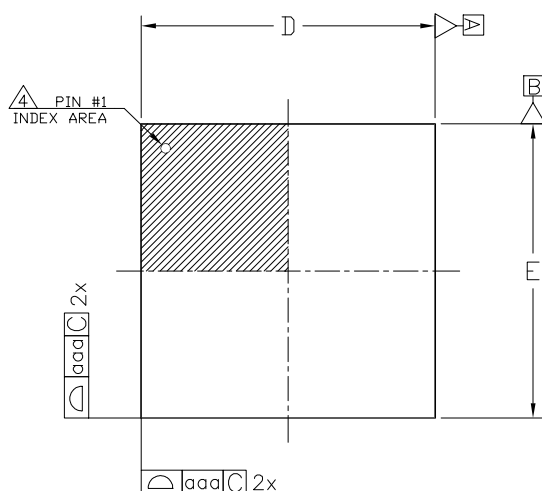

[TOP VIEW]

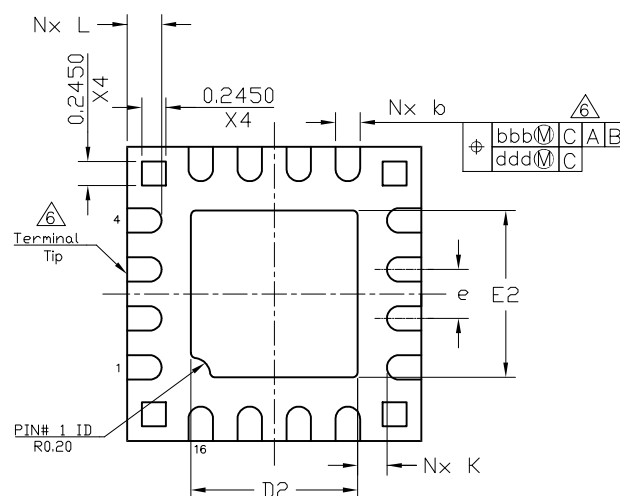

[BOTTOM VIEW]

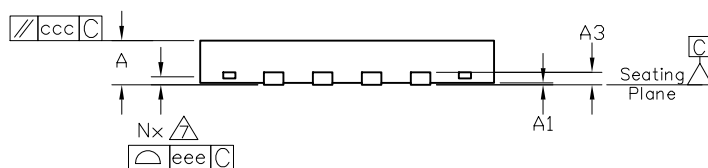

[SIDE VIEW]

NOTES:

1. Dimensioning and tolerancing conform to ASME Y14.5–2009.

2. All dimensions are in millimeters.

3. N is the total number of terminals.

△ The location of the marked terminal #1 identifier is within the hatched area.

5. ND and NE refer to the maximum number of terminals on each D and E side respectively.

△ Dimension b applies to the metallized terminal and is measured between 0.15mm and 0.30mm from the terminal tip. If the terminal has a radius on the other end of it, dimension b should not be measured in that radius area.

△ Coplanarity applies to the terminals and all other bottom surface metallization.

Dimension Table

Symbol	Thickness	Min	Nominal	Max	Note
A		0.41	0.45	0.50	
A1		0.00	0.02	0.05	
A3		---	0.127 Ref.	---	
b		0.18	0.25	0.30	6
D		3.00 BSC			
E		3.00 BSC			
e		0.50 BSC			
D2		1.55	1.70	1.80	
E2		1.55	1.70	1.80	
K		0.20	---	---	
L		0.25	0.35	0.45	
aaa		0.05			
bbb		0.10			
ccc		0.10			
ddd		0.05			
eee		0.08			
N		16			3
ND		4			5
NE		4			5

Package Size: 3.0x3.0x0.45mm

Exposed Pad Size: 1.7x1.7mm

PIN Pitch: 0.5mm

Number of Pad: 17

Remarks:

Date: 2022/06/30

Title: 8TR-3x3-16L-POD1-P220630

Version: Rev1.0

BeRex Confidential



Land Pattern Recommendation

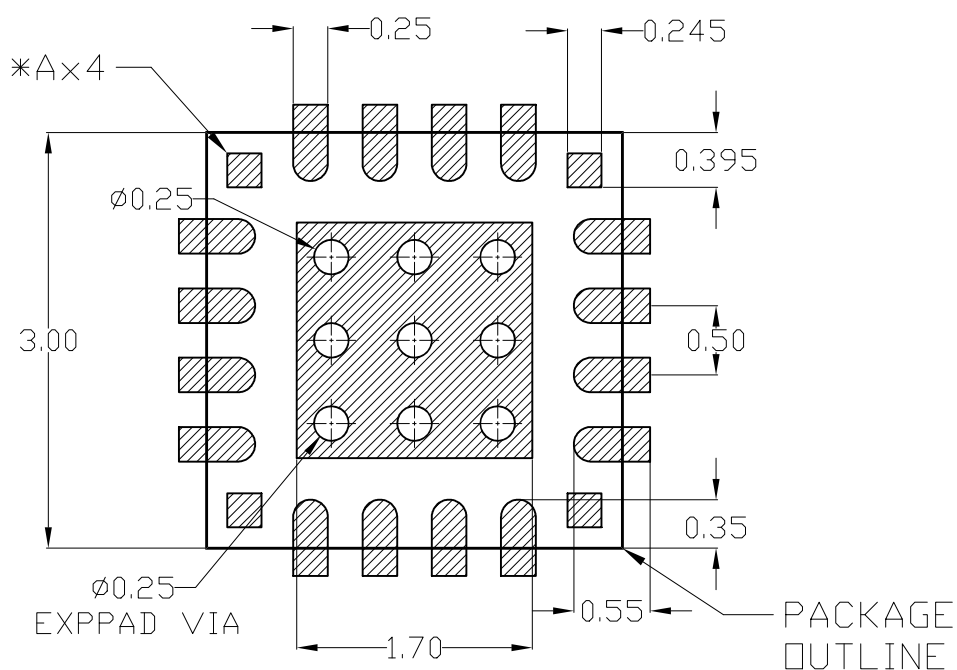

NOTES:

- 1.All dimensions are in millimeters.
- 2.*Ax4 are connected with Exposed Pad.

Exposed Pad Size: 1.7x1.7mm	Remarks:
PIN Pitch: 0.5mm	Date: 2022/06/30
Number of Via: 9	Title: 8TR-3x3-16L-POD1-P220630
Via diameter: 0.25mm	Version: Rev1.0
Exposed Pad via pitch: 0.6mm	
<i>BeRex Confidential</i>	